

# COLLEGE OF STATEN ISLAND

# 2024 UNDERGRADUATE CONFERENCE

RESEARCH, SCHOLARSHIP, AND THE ARTS



**THURSDAY, MAY 2, 2024**

**[www.csi.cuny.edu/ugconference](http://www.csi.cuny.edu/ugconference)**



College of Staten Island  
The City University of New York





Sponsored by  
the Division of  
Academic Affairs with  
special thanks to all of  
our community and campus  
partners who supported this  
conference: Northfield Bank, and the  
CSI Alumni Association.



## Message from the President



Undergraduate research is one of the hallmarks of a top-tier institution, and the College of Staten Island can truly claim a legacy of this activity. Our faculty work with and involve students in an impressive array of high-impact practices, providing meaningful exposure to research in the sciences, humanities, business, education, and performing and creative arts, as well as the social and health sciences. What you see before you is the culmination of hundreds of hours of activity in laboratories, archives, and elsewhere. The dedication of our faculty in supporting these efforts is matched only by the enthusiasm and talented contributions of their student counterparts.

The activities you see on display at this event are proof that hands-on, experiential learning is key to a college curriculum. Through undergraduate research, our students are able to apply the theories, concepts, and constructs they learned about in lecture to the real world. The linkage of theoretical and applied knowledge is a crucial component of undergraduate education, and represents the very best of both teaching and learning.

The annual Undergraduate Research Conference is, along with Commencement, one of the proudest days for the College of Staten Island. It allows us to celebrate the accomplishments of so many students in so many disparate areas; I am pleased to share with you all the hard work of our students and their faculty mentors. Enjoy the event!

Sincerely,

A handwritten signature in black ink that reads "Timothy G. Lynch". The signature is written in a cursive, flowing style with a large initial 'T' and 'L'.

Timothy G. Lynch, Ph.D. (*he/him/his*)  
President

## CSI Undergraduate Conference on Research, Scholarship, and the Arts Thursday, May 2, 2024

- Noon–4:00pm**      **Exhibitions - The Art Gallery of the College of Staten Island**  
 1P-112  
*The Waking Dreams of Phantasmata Traumata*  
 This exhibition presents supernatural collaborations, invitations for paranormal visitation, psychic predictions, and uncanny mediations. Join us for an exhibition of paintings, objects, moving images, and otherworldly guests.  
*This exhibition is curated by Prof. Siona Wilson (with Prof. Cynthia Chris)*
- Noon-1:00pm**      **Lunch available to participating students and mentors**  
 1P-116 (pick up)
- 1:00pm–2:00pm**      **Plenary Session**  
 Williamson Theatre, 1P-111  
**Musical Introduction**  
     Angel Muñoz-Avila (Class of '25), Harpist  
**Welcome and Introductions**  
     Laxmi Ramasubramanian - Associate Provost  
**Opening Remarks**  
     Michael E. Steiper - Interim Provost/Senior Vice President for Academic Affairs  
**Keynote Address**  
     Charles Liu - Professor of Astrophysics  
*Can You Hear The Music? Barbenheimer, The Multiverse, And You*  
**Remarks from Sponsors**  
**Closing Vocal Performance**  
     Diana Claps (Class of '24), Mezzo-Soprano, with Prof. Sylvia Kahan on piano
- 2:00pm–4:00pm**      **Poster Presentations**  
 1P Atrium
- 2:30pm-3:00pm**      **Theater - Performing and Creative Arts - Drama Program**  
 Williamson Theatre, 1P-111  
 A scene from “Workshopping Mary Zimmerman’s Play *Metamorphosis: A Student Collaboration with Professor Maurya Wickstrom*”
- 2:30pm-4:00pm**      **Exhibitions - The Student Art Gallery**  
 1P-118B  
 A juried group exhibition of student art curated by PCA student curators Axel Delgado, Janinne Aguayza-Calle, Victoria Paradiso, and Emily Wu (Faculty Adviser: Prof. Beth Livensperger)
- 3:00pm-4:00pm**      **Music Hour - Performing and Creative Arts - Music Program**  
 Williamson Theatre, 1P-111  
 Musical performances featuring Composition Students, Senior Recital Performers, and Ensembles from the Performing and Creative Art Department’s Music Program. Featuring private students of Professors Sylvia Kahan, Johnna Nan Wu, and Elena Heimur, as well as ensembles directed by Professors Ed Brown (CSI Guitar Ensemble), Vincent Guarna (The CSI Jazz Combo), and Darrell Smith (The CSI Jazz Ensemble).
- 4:00pm-4:20pm**      **Film Screenings and Posters - Media Culture**  
 Williamson Theatre, 1P-111  
 Films, videos, and posters (representing advanced design and digital media) presented by students from the Department of Media Culture.
- 4:20pm-4:40pm**      **Poetry Reading - English Department**  
 Williamson Theatre, 1P-111  
 Students present their original works of poetry.

THE DEPARTMENT OF  
PERFORMING AND CREATIVE ARTS  
AND THE DEPARTMENT OF MEDIA CULTURE

PRESENT

# **AN ART AND MUSIC EXPOSITION**

AT THE

**23rd Annual  
CSI Undergraduate Conference  
on Research, Scholarship,  
and the Arts**

---

**Plenary**

---

Williamson Theatre, 1P-111

1:00pm-2:00pm

**PCA Music Program**

Musical Introduction

“Seguidilla” from *Suite of Eight Dances* ..... Carlos Salzedo

“Tango” from *Suite of Eight Dances* ..... Carlos Salzedo

**Angel Muñoz-Avila**, *harp*

*Mentored by Prof. Chelsea Lane*

Closing Performance

“Una Voce Poco Fa” from *The Marriage of Figaro* ..... Gioachino Rossini

**Diana Claps**, *mezzo-soprano*

**Prof. Sylvia Kahan**, *piano*

*Mentored by Prof. Elena Heimur*

---

**Theater**

---

Williamson Theatre, 1P-111

2:30pm

**PCA Drama Program**

A Scene from “Workshopping Mary Zimmerman’s Play *Metamorphosis*:  
*A Student Collaboration with Professor Maurya Wickstrom*”

**CAST**

Vincent DeLuca

Tommy DeVito

Tareq Farag

Emma Ferguson

Derrick Kinsey

Giovanna Rotondo

Regan Sou

Maria Lee Vazquez

---

**Music Hour**

---

Williamson Theatre, 1P-111

3:00pm-4:00pm

**PCA Music Program**

Etude in F minor, Op. 10, no. 9 ..... Frédéric Chopin

**Xiaoying Amber Liang**, *piano*  
*Mentored by Prof. Sylvia Kahan*

Vocalise ..... Serge Rachmaninoff

**Jerrol Bowman**, *violin*  
**Xiaoying Amber Liang**, *piano*  
*Mentored by Prof. Sylvia Kahan and Prof. Johnna Nan Wu*

“Ch’io mi scordi di te,” K. 505 ..... Wolfgang A. Mozart

**Diana Claps**, *mezzo-soprano*  
**Prof. Sylvia Kahan**, *piano*  
*Mentored by Prof. Elena Heimur*

**CSI Guitar Ensemble**, *directed by Prof. Ed Brown*

**Matthew Asmat**  
**Jenny Brown**  
**Ryan Chisefsky**  
**Joshua Crespo**  
**Anthony Delcore**  
**Mano Merca**

**Maksim Nam**  
**Angelina Resoso**  
**Javier Luis Santos**  
**Sasha Samsonovich**  
**Niamh Alarcon**  
**Andrew Yip**

Flamenco Fantastico ..... David Burndrett

Adelita ..... Francisco Tárrega

**Mano Merca**, *guitar*

Django’s Stomp ..... David Bruce

Góndola veneciana, Op. 19, No. 6 ..... Felix Mendelssohn, trans. Francisco Tárrega

**Anthony Delcore**, *guitar*



Ghostbusters ..... Ray Parker Jr., arr. Derek Hasted

**The Ensemble**

**The CSI Jazz Combo**, *directed by Prof. Vincent Guarna*

**Anthony Delcore**, *Guitar*

**Andres Romero**, *Drums*

**Steven Tyler Tindall**, *Electric Bass*

Recordame ..... Joe Henderson

What Is This Thing Called Love? ..... Cole Porter

**The CSI Jazz Ensemble**, *directed by Prof. Darrell Smith*

**Daniel Joseph Bayer, Kristen Sparacio and Robin Whalen**, *Trumpet*

**Kevin Mcgetrick**, *Trombone*

**Madisen Cutler**, *Flute/Clarinet*

**Brianna Dellaccio**, *Clarinet*

**Theresa M. Pagani**, *Alto Sax*

**Nicholas Michelizzi**, *Tenor Sax*

**Sasha Samsonovich**, *Tenor Sax*

**Erik Davis**, *Tenor Sax*

**Lawrence Levin**, *Piano*

**Anthony Declore**, *Guitar*

**Steven Tyler Tindall**, *Bass*

**Andres Romero**, *Drums*

**Genevieve E. Steinmetz**, *Vocalist*

In a mellow tone ..... Duke Ellington

Ellington's sound of Love ..... Charles Mingus

Bachafillen ..... Garnett Brown

---

**Film Screenings and Posters**

---

Williamson Theatre, 1P-111

4:00pm

**Department of Media Culture**

Moving image work

**Girl with a Movie Camera**

by Karena Pang

Cinema Production Major

*film, approx. 5min*

**Boxing Legends**

by Keith Clemons

COM Design & Digital Media Major

*animation, 2min, 30sec*

**Will (and a Musical Showcase of Anxious Chaos)**

by Robert Lenza (with live soundtrack by Joe Miele)

Cinema Production Major

film with live performance, approx. 10min

**Posters to be exhibited inside the Williamson Theatre representing**

**Advanced Design & Digital Media creative work:**

Embrace Humanity, Reject Artificiality *by Jeremiah Alonso*

Café Juliet *by Samantha Carreon*

Pillars of Progress *by Jaden Etienne*

Amara: Branding a Musical Artist *by Deanna Garcia*

What does fashion mean to you? *by Isabella Giuliani*

Italian Posters *by Timothy Lauser*

Teapot Tales *by Kate Leung*

Why Neuralink *by Dominic Moore*

Elena and Her Pet Rabbit *by Pricila Ortega Ramos*

Can You Hear Me? *by Kafui Vowotor*

A Day In The Life...(a short graphic novel) *by Yessenia Zosayas*

**Poetry**

Williamson Theatre, 1P-111

4:20pm

**English Department**

Poetry Reading

**Original Poetry by**

Kelliann D'Ambrosio

Jordana Cristino

Louis Perrotti

Amina Selimaj

Kai White

**Exhibitions**

1P-112

Noon–4:00pm

**The Art Gallery of the College of Staten Island**

*The Waking Dreams of Phantasmata Traumata*

Does an artwork dream? Let's imagine that the material, the medium of a created thing can also be a medium of another kind. A mystic, a clairvoyant, a soothsayer that augurs better futures, purges injuries of the soul, and connects us with the unhappy ghosts of our cruel world. The artwork as medium might be a channel to awaken other pasts (and the pasts of others), transform the present, and reshape what is to come. *The Waking Dreams of Phantasmata Traumata* explores the psychic lives of artworks when the artist is forgotten. The exhibition presents supernatural collaborations, invitations for paranormal visitation, psychic predictions, and uncanny mediations. Join us at the Art Gallery of The College of Staten Island for an exhibition of paintings, objects, moving images, and otherworldly guests.

*This exhibition is curated by Prof. Siona Wilson (with Prof. Cynthia Chris)*

1P-118B

2:30pm–4:00pm

**The Student Art Gallery of the College of Staten Island**

**Undergraduate Research Conference Art Exhibition**

A juried group exhibition of student art curated by PCA student curators

Axel Delgado, Janinne Aguayza-Calle, Victoria Paradiso,  
and Emily Wu (Faculty Adviser: Prof. Beth Livensperger)

# Poster Floor Plan

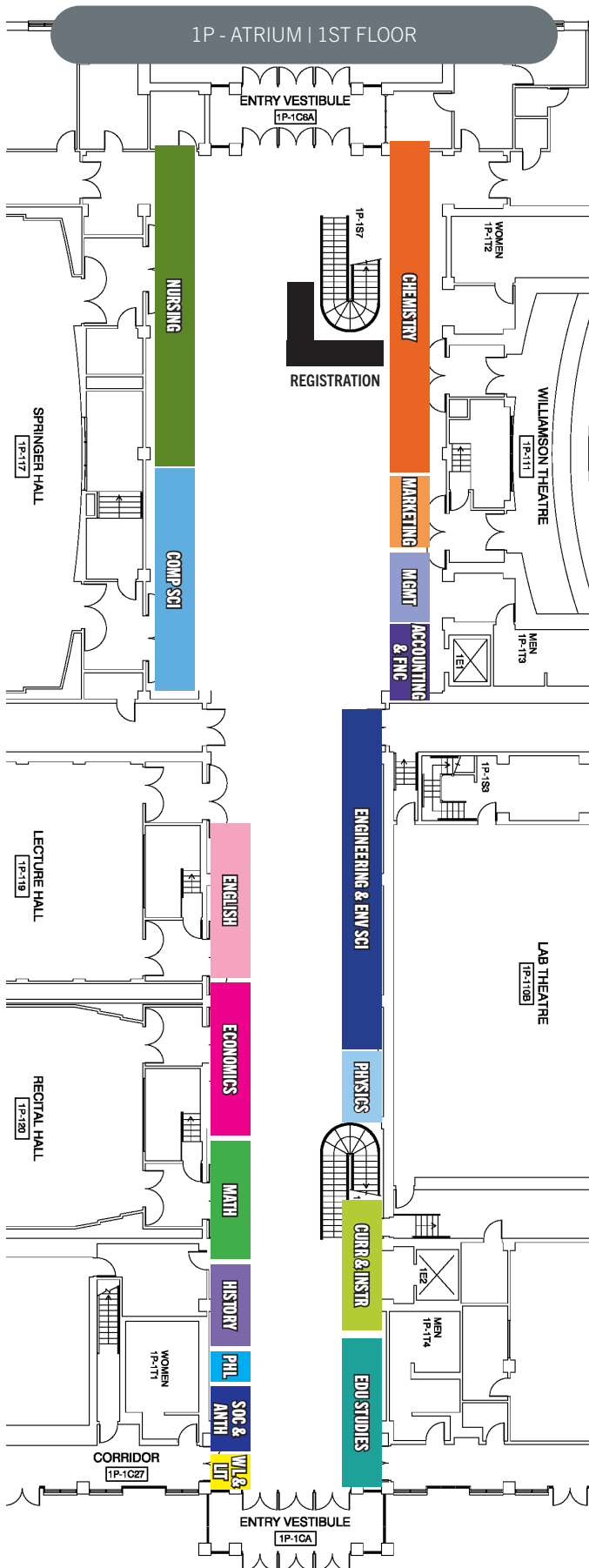

<span style="color: purple;">■</span> <b>ACCOUNTING &amp; FINANCE</b> 1st Floor - Front Entrance North Wall (Williamson Theater)
<span style="color: magenta;">■</span> <b>BIOLOGY</b> 2nd Floor – West Lounge and Walkway
<span style="color: orange;">■</span> <b>CHEMISTRY</b> 1st Floor - Front Entrance North Wall (Williamson Theater)
<span style="color: blue;">■</span> <b>COMPUTER SCIENCE</b> 1st Floor - Front Entrance South Wall (Springer Hall)
<span style="color: green;">■</span> <b>CURRICULUM &amp; INSTRUCTION</b> 1st Floor - Back Entrance - North Wall
<span style="color: magenta;">■</span> <b>ECONOMICS</b> 1st Floor - Center - South Wall (Lecture/Recital Halls)
<span style="color: teal;">■</span> <b>EDUCATIONAL STUDIES</b> 1st Floor - Back Entrance - North Wall
<span style="color: darkblue;">■</span> <b>ENGINEERING &amp; ENV. SCIENCE</b> 1st Floor - Center - North Wall (Lab Theater)
<span style="color: pink;">■</span> <b>ENGLISH</b> 1st Floor - Center South Wall (Lecture/Recital Halls)
<span style="color: purple;">■</span> <b>HISTORY</b> 1st Floor - Back Entrance - South Wall
<span style="color: blue;">■</span> <b>MANAGEMENT</b> 1st Floor - Front Entrance North Wall (Williamson Theater)
<span style="color: orange;">■</span> <b>MARKETING</b> 1st Floor - Front Entrance North Wall (Williamson Theater)
<span style="color: green;">■</span> <b>MATHEMATICS</b> 1st Floor - Center - South Wall (Lecture/Recital Halls)
<span style="color: green;">■</span> <b>NURSING</b> 1st Floor - Front Entrance South Wall (Springer Hall)
<span style="color: blue;">■</span> <b>PHILOSOPHY</b> 1st Floor - Back Entrance - South Wall
<span style="color: lightblue;">■</span> <b>PHYSICS</b> 1st Floor - Center - North Wall (Lab Theater)
<span style="color: red;">■</span> <b>POLI. SCI. &amp; GLOBAL AFFAIRS</b> 2nd Floor – Walkway (Williamson Hall)
<span style="color: blue;">■</span> <b>PSYCHOLOGY</b> 2nd Floor – East Lounge
<span style="color: darkblue;">■</span> <b>SOCIOLOGY &amp; ANTHROPOLOGY</b> 1st Floor - Back Entrance - South Wall
<span style="color: yellow;">■</span> <b>WORLD LANGUAGES &amp; LIT.</b> 1st Floor - Back Entrance - South Wall

# Poster Floor Plan

1P - 2ND FLOOR - WEST LOUNGE

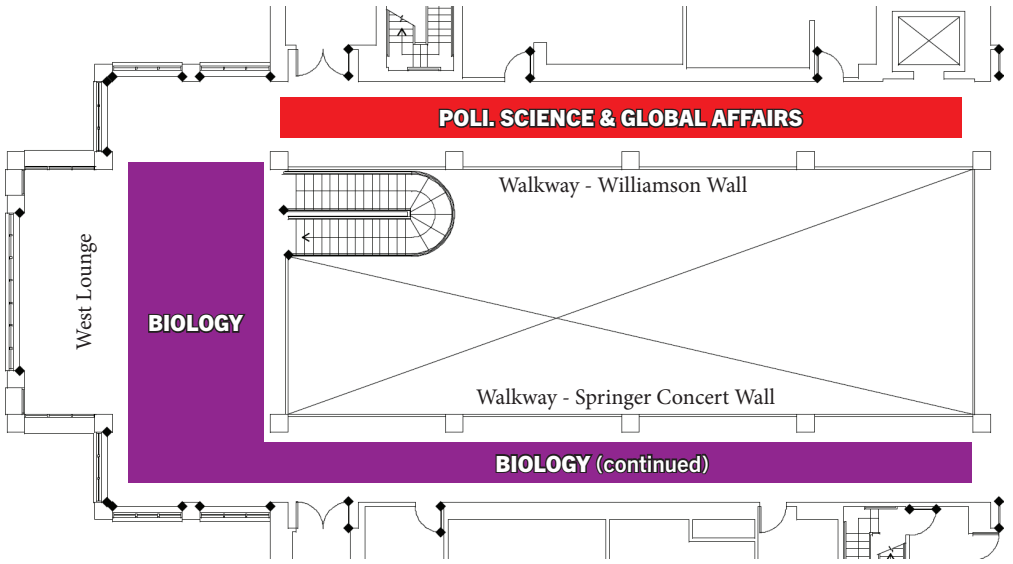

1P - 2ND FLOOR - EAST LOUNGE

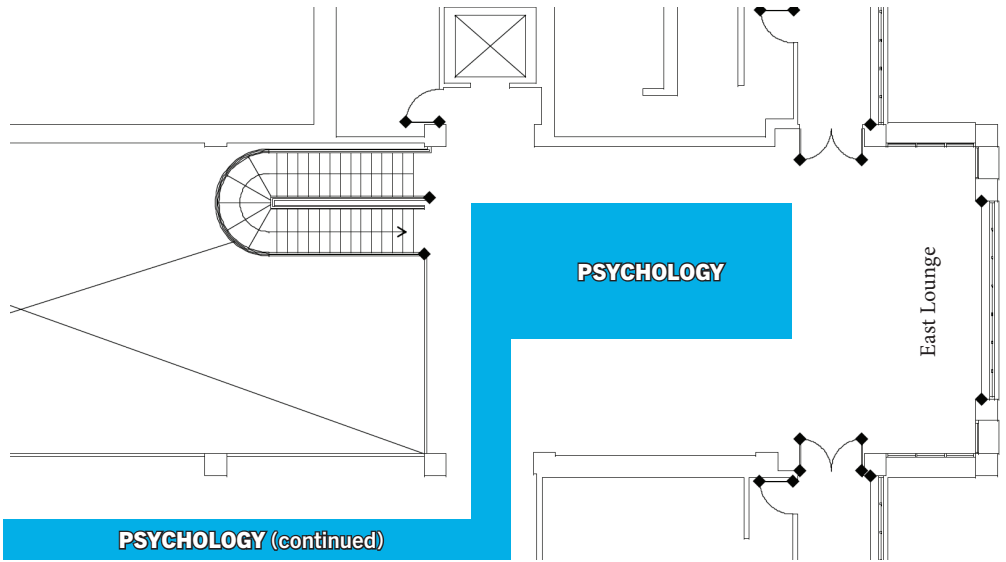



# **POSTER PRESENTATIONS**

Center for the Arts  
2:00pm-4:00pm

---

## ACCOUNTING AND FINANCE

---

### ACC/FNC-01

#### The Effects of Sustainability Performance Metrics on the Financial Performance of Pharmaceutical Companies in New York Stock Exchange

Leah A Vega

Faculty Mentor: Professor Banu Aslanertik

### ACC/FNC-02

#### Impact of Technology on Financial Fraud Investigations

Yamely Garcia

Faculty Mentor: Professor Patricia Galletta

---

## BIOLOGY

---

### BIO-01

#### The Effect of Tau on Neuroblastoma Cell Cycle and Growth

Sandi Kelada

Faculty Mentor: Professor Alejandra Alonso

### BIO-02

#### The Six Isoforms of Tau: Insights on Their Differences and Levels of Toxicity in the Brain

Jessica N Ifeanyi

Faculty Mentor: Professor Alejandra Alonso

### BIO-03

#### Taurine Regulation of Blood Pressure and Vascular Resistance: A Literature Review

Irene Kalogiannis

Faculty Mentor: Professor Abdeslem El Idrissi

### BIO-04

#### The Effect of JZL-184 on Repetitive Behavior in the BTBR Mouse Model of Autism Spectrum Disorder

Milena E Olkhovetsky

Faculty Mentor: Professor Michelle Esposito

### BIO-05

#### The Impact of Human Activities on Zoonotic Infection Transmissions

Sara Turku, Leora Lehrfield

Faculty Mentor: Professor Michelle Esposito

### BIO-06

#### Exploring the Vast Emotions of Cows: The Importance of Awareness for Ethical Treatment in the Food Industry

Arianna Brillante

Faculty Mentor: Professor Ann N Etsey

### BIO-07

#### Development of a Cost-Effective Mechanical Scanning Platform for Prosthetic Surface Mapping and 3D Additive Manufacturing

Edward Leibowitz

Faculty Mentor: Professor Jimmie Fata

### BIO-08

#### The Development of a Python Computer Code Capable of Finding Novel Anti-Cancer Compounds against Triple Negative Breast Cancer

Xinyi Weng

Faculty Mentor: Professor Jimmie Fata

### BIO-09

#### **Reviewing the Role of Carbon Dioxide for Seizure Intervention in Humans and African Naked Mole-Rats**

Rebecca A Andes

Faculty Mentor: Professor Antonella Guadagnino

### BIO-10

#### **Sorting Patterns of Human Leukocyte Antigen Expression in Glioblastoma Multiforme (GBM)**

Naomi A Akan, Raeshawn E Gibson

Faculty Mentor: Professor Nancy Liu-Sullivan

### BIO-11

#### **Tumor Grade Associated Collagen Signatures and Overall Patient Survival in Gliomas: A Developing Story**

Caitlin R Carela, Ambar Alvarenga, Melina Turco

Faculty Mentor: Professor Nancy Liu-Sullivan

### BIO-12

#### **An Observational Study of Water Contaminants and High Cancer Incidence on Staten Island**

Rachel Tbeile, Lily Chen, Yuliya Kim, Eve Deans, Fiona Shehu, Marie Darlande Toussaint, Husein Bechara

Faculty Mentor: Professor Nancy Liu-Sullivan

### BIO-13

#### **Exploratory Behavior: Study of Young and Experienced Lesser Black-backed Gulls**

Brian Kerliu

Faculty Mentor: Professor Lisa Manne

### BIO-14

#### **The Influence of Bird's Traits on Geographic Range Size**

Morgan Novello

Faculty Mentor: Professor Lisa Manne

### BIO-15

#### **Impact of Habitat Quality on Dispersal Distance of Gray Catbirds**

Joey Yu

Faculty Mentor: Professor Lisa Manne

### BIO-16

#### **The Detectives in Labcoats: Medical Laboratory Scientists**

Ayah Atmani

Faculty Mentor: Professor Adrienne Paez

### BIO-17

#### **An Analysis of the Interplay between Obesity, Gut Microbiota, and the Gut-Brain-Axis**

Saira Ahmad

Faculty Mentor: Professor Faiza Peetz

### BIO-18

#### **Understanding the Relationship between Gut-Brain Axis and Depression; Contemplation of New Treatment for Depression**

Branny De Jesus Santana

Faculty Mentor: Professor Faiza Peetz



**BIO-19****Microbiome and Anxiety**

Sandra Ghobrial

Faculty Mentor: Professor Faiza Peetz

**BIO-20****Microbiome-Gut-Brain Axis, Immune Dynamics, and Neurological Well-Being**

Anxhela Josifi

Faculty Mentor: Professor Faiza Peetz

**BIO-21****Global Research Trends in Microbiome-Gut-Brain Axis during 2019-2024: A Bibliometric and Visualized Study**

Anxhela Josifi

Faculty Mentor: Professor Faiza Peetz

**BIO-22****Research on Gut Bacteria in Relationship to ADHD**

Mohammad Anas Kasem

Faculty Mentor: Professor Faiza Peetz

**BIO-23****Deciphering the Gut-Brain Connection: The Role of Gut Dysbiosis in Inducing Tau Hyperphosphorylation and Alzheimer's Disease Pathogenesis**

George N Khoury

Faculty Mentor: Professor Faiza Peetz

**BIO-24****Literature Review Exploring the Gut-Brain-Axis: Gut Microbiome Link with the Brain & Potential Neurological Disorders from Gut Dysbiosis**

George N Khoury

Faculty Mentor: Professor Faiza Peetz

**BIO-25****Microbiome-Gut-Brain-Axis and Autism**

Salwa Munir

Faculty Mentor: Professor Faiza Peetz

**BIO-26****Microbiome-Gut-Brain-Axis and Autism, Mechanisms of Action**

Salwa Munir

Faculty Mentor: Professor Faiza Peetz

**BIO-27****The Intricate Interplay: Exploring the Dynamic Relationship between the Gut-Brain Axis and Microbiota in Human Physiology**

Julia Palka

Faculty Mentor: Professor Faiza Peetz

**BIO-28****Microbiome Gut Brain Axis and Diabetes**

Amina Ziani

Faculty Mentor: Professor Faiza Peetz

### BIO-29

#### **The Implication of INO80 Acetylation in Transcriptional Activation**

Mary C Butler, Anusha Haris

Faculty Mentor: Professor Chang-Hui Shen

### BIO-30

#### **2,4-Dinitrotoluene Responsive Gene Expression Pattern in Pseudomonas Putida**

Albert Mackiewicz

Faculty Mentor: Professor Chang-Hui Shen

### BIO-31

#### **The Impact of the COVID-19 Pandemic on College Students' Lives: Exploring the Shift to Online Learning and Its Influence on Study Habits in Conjunction with Technological Advancements in Education**

Raghad Alhanoun

Faculty Mentor: Professor Grozdena Yilmaz

### BIO-32

#### **African American Female Maternal Mortality in the United States**

Tiana Garcia

Faculty Mentor: Professor Grozdena Yilmaz

### BIO-33

#### **Effect of Angiotensin Receptor Blockers on the Progression of Diabetic Nephropathy**

Andrew W Ngai

Faculty Mentor: Professor Muhammad Zia

### BIO-34

#### **Literature Review on Benefits of SGLT2 Inhibitors in Decreasing Cardiovascular Morbidity and Mortality in Individuals with Diabetes Mellitus**

Marcelina Rokicki, Joey Yu, Inna Alieva,

Alla Gubskiy

Faculty Mentor: Professor Muhammad Zia

### BIO-35

#### **Comparative Literature Review of Parkinson's Disease Intervention**

Gadzhi Shakhnavazov, Luciano Spagnuolo

Faculty Mentor: Professor Muhammad Zia

---

## **CHEMISTRY**

---

### CHM-01

#### **Determining the Background Rate of Congenital Viral Infections in Healthy Males in a Community-based Hospital Population**

Daniel Wronski

Faculty Mentor: Professor Leah Cohen

### CHM-02

#### **S100A12 and CD36: Investigating their Binding Affinity and the Implications for the Treatment of Inflammatory Diseases**

Ahava Collado

Faculty Mentor: Professor Rupal Gupta

**CHM-03****Optimizing Photodynamic Therapy for Wound Treatment: Influence of E. coli Concentration and Photosensitizer Presentation**

Aya Ashour

Faculty Mentor: Professor Alan Lyons

**CHM-04****Exploring the Efficacy of Hydrophobic Glass in Solar Panel Maintenance: The Effect of Time and Temperature on Water Droplet Formation During Condensation**

Anthony P Attenborough

Faculty Mentor: Professor Alan Lyons

**CHM-05****Lotus Stems as Scaffolds for 3D Cell Culture and Bioengineering**

Bora Kupa, Theresa Pagani, Judie Hamdan, Kishan Kallurya, Viktoriya Morozova, Nicole Lamassa, Michael Bucaro

Faculty Mentor: Professor Krishnaswami Raja

**CHM-06****Characterization of Solution Blow-Spun PLGA/Turmeric Nanocomposites**

Victoria Cannava, Theresa Pagani, Kraya Macwan, Kehinde Aiyegboyin, Kishan Kallurya, Shannon Killen, Zaghoul Ahmed

Faculty Mentor: Professor Krishnaswami Raja

**CHM-07****History of Baking**

Julia Kalinowski, Sabrina Musovic, Tasneem Ahsan, Emily Ricciutti, Tasnim Hanaif, Adrianna Catanzaro

Faculty Mentor: Professor Krishnaswami Raja

**CHM-08****Propagation of Lotus Plants and Preparation and Characterization of Lotus Stem Biocomposites**

Kraya Macwan, Bora Kupa, Joel Christian, Larisa Borruso, Kishan Kalluraya, Michael Bucaro

Faculty Mentor: Professor Krishnaswami Raja

**CHM-09****Advanced Nanoengineering for Glucose Sensing and Drug Delivery Systems**

Sakina Saeed

Faculty Mentor: Professor Shuiqin Zhou

**CHM-10****The Influence of Carbon Dots Concentration on the Hydrodynamic Size and Zeta Potential of Chitosan-Carbon Dots Hybrid Nanogels**

Salma Balogun

Faculty Mentor: Professor Shuiqin Zhou

**CHM-11****VPBA -NIPAM Microgels for Optical Glucose Sensors**

Bhakti Dongerkery

Faculty Mentor: Professor Shuiqin Zhou

### CHM-12

#### **Optimization of Chitosan Nanogel: Effect of Chitosan Concentration and Crosslinker Percentage on Hydrodynamic Size of Chitosan Nanogels**

Estella Kosse

Faculty Mentor: Professor Shiquin Zhou

---

## **COMPUTER SCIENCE**

---

### CSC-01

#### **Quaternion-based Remote Photoplethysmography for Continuous Heart Rate Monitoring**

Nicholas Basile, Maxim Kleyer

Faculty Mentor: Professor Sos Agaian

### CSC-02

#### **Beneath the Binary: A Journey into Covert Communication**

David Liao

Faculty Mentor: Professor Sos Agaian

### CSC-03

#### **Pokemon World Champion Edition**

Michael A Aurilia

Faculty Mentor: Professor Tatiana Anderson

### CSC-04

#### **Cybersecurity Threats to Healthcare Organizations: A Case Analysis of Northwell Hospital**

Mirjana Mehmeti

Faculty Mentor: Professor Soon Ae Chun

### CSC-05

#### **The Health of AI in the Medical Field**

Robert Wetz

Faculty Mentor: Professor Susan Imberman

### CSC-06

#### **How Well Can AI Diagnose Using Chest X-Ray Data?**

Conor Farrell

Faculty Mentor: Professor Sarah Zelikovitz

### CSC-07

#### **From Shopping Cart to Trash Can: A Data-focused Study of How American Families Waste Food**

Andi Kolari, Savion E Watson, Gabrielle A Erves

Faculty Mentor: Professor Sarah Zelikovitz

### CSC-08

#### **Streamlining Data Analysis of FloodNet Sensors**

Marco Korcak, Madison DeGrezia, Justin Zaluk

Faculty Mentor: Professor Zhanyang Zhang

---

## **CURRICULUM & INSTRUCTION**

---

### C&I-01

#### **Combining Play-based Mathematical Learning and Computational Skills with the Use of an Online Coding Program, Scratch**

Rolla Khass, Bayan Khalil

Faculty Mentor: Professor Judit Kerekes

**C&I-02**

**Curriculum Analysis of Interpreting Linear Functions**

Reyam Ghannoum

Faculty Mentor: Professor Wenjuan Li

**C&I-03**

**Computational Storytelling for STEAM Education in the Early Childhood**

Rolla Khass

Faculty Mentor: Professor Ting Yuan

---

**ECONOMICS**

---

**ECO-01**

**Economic and Financial Dynamics in Luxury Fashion**

Qadar Naeem

Faculty Mentor: Professor Paul Orzechowski

**ECO-02**

**Income Convergence Hypothesis**

Seifeldin Awad, Almir Gashi, Ismaila Keita

Faculty Mentor: Professor George Vachadze

**ECO-03**

**Economic Growth and Environmental Degradation**

Hailey Germoso, Qadar Naeem, Stephen Teiglee

Faculty Mentor: Professor George Vachadze

**ECO-04**

**Harvesting Growth: A Global Comparative Analysis of GDP Growth and Arable Land Availability**

Thomas A Lovascio

Faculty Mentor: Professor George Vachadze

**ECO-05**

**Unraveling the Impact of Income Inequality on GDP Growth Rate and GDP Growth Rate Volatility**

Thomas Mishakin, Chazz Chambliss, John Agro

Faculty Mentor: Professor George Vachadze

**ECO-06**

**Natural Resources Impact and Correlation to Economic Growth**

Shontel D Nedderman

Faculty Mentor: Professor George Vachadze

**ECO-07**

**The Influence of Political Stability and the Rule of Law on the Tourism Industry**

Evelyn J Tamay Flores

Faculty Mentor: Professor George Vachadze

**ECO-08**

**Effect of the COVID-19 Pandemic on Time Spent on Educational Activities**

Michael Levitas

Faculty Mentor: Professor Alexandru Voicu

---

**EDUCATIONAL STUDIES**

---

**EDD-01**

**Should Vocational Training Be Included in High School Education?**

Lauren Cardieri

Faculty Mentor: Professor Deirdre Armitage

**EDD-02**

**In What Ways, If Any, Can Art Integration Enhance Student Engagement in the General Education Elementary Classroom?**

Jaclyn Regina

Faculty Mentor: Professor Marta Cabral

**EDD-03**

**The Important Role of the Rekenrek in Child Development and Number Sense**

Jessica Abrajan, Nadeen Ahmad,

Francesca Papalia

Faculty Mentor: Professor Judit Kerekes

**EDD-04**

**Number Sense Adventures**

Abeer Ramadan, Erin Westgate,

Ava Degratto, Lauren Farley

Faculty Mentor: Professor Judit Kerekes

**EDD-05**

**Incorporating an ASL Curriculum for Students in Grades 1-6**

Gianna Occhiuto

Faculty Mentor: Professor Russell Rosen

---

**ENGINEERING &  
ENVIRONMENTAL SCIENCE**

---

**EES-01**

**Experimental Characterization of Plastic Optical Fibers for Under- and Over-Filled Injections**

Frank Feng, Ali Abdelmoneim

Faculty Mentor: Professor Neo Antoniades

**EES-02**

**A Novel Optical Test Bed for Measuring the Light Transmission Properties of Plastic Optical Fiber under Bending**

Eric Huang

Faculty Mentor: Professor Neo Antoniades

**EES-03**

**Transforming Daily Tasks for Visually Impaired Seniors: Leveraging an Open AI Model-Enhanced Multimodal Dialogue System with Speech Recognition in POF Smart Homes**

Jason Zheng, Jackson Haft, Paloma Almonte

Faculty Mentors: Professor Neo Antoniades & Professor Yi Wang (Manhattan College)

**EES-04**

**A Sensitivity Study of the Contribution of Cross Sections in the Calculation of Bone Sample Modulus of Elasticities During Micro Tensile Testing**

Lawrence Goldfeld

Faculty Mentor: Professor Jean-Philippe Berteau

**EES-05****Extending the Battery Life in the Utility-Scale Solar Power Field**

Guohong Zhao, Thanh Truong

Faculty Mentor: Professor Xin Jiang

**EES-06****Crochet Stitch Counter**

Danielle Aurilia, Fady Soliman

Faculty Mentor: Professor Alfred Levine

**EES-07****Plant Watering System**

Ezekiel O Okedoyin, Joseph Williams

Faculty Mentor: Professor Alfred Levine

**EES-08****Audio Signal Generator to Alter Plant Behavior**

Bryan Rudshiteyn, Joseph Grillo, Stephen Dorazio

Faculty Mentor: Professor Alfred Levine

**EES-09****Emergency Communication App**

Warren Shum, Ali Abdelmoneim

Faculty Mentor: Professor Alfred Levine

**EES-10****Improving Drinking Water Contamination Detection**

Thomas J Strmel, Emmanuel Ijasuyi, Marroquin Marcia

Faculty Mentor: Professor Alfred Levine

**EES-11****Temperature Sensor DC Fan with LED as Its Indicator**

Abou Bah

Faculty Mentor: Professor Dimitrios Pavlidis

**EES-12****Facilitating Working on Wind Turbines Using the Nacelle Wind Turbine as a Learning System**

Fady U Frieg

Faculty Mentor: Professor Syed Rizvi

**EES-13****A Geospatial Analysis of Sea Level Rise and Flooding of Queens, New York**

Alondra Camacho

Faculty Mentor: Professor Sean Thatcher

---

**ENGLISH**

---

**ENG-01****Emphasis in Speech: The Individual's Perspective**

Thikra Mohammad, Jade Smith, Ashley Mesa, Kayla Goldstein

Faculty Mentor: Professor Jason Bishop

**ENG-02****Treatment Efficacy for Childhood Apraxia of Speech: A Review Of Literature**

Raijan Peters

Faculty Mentor: Professor Lorenza Colonna

### ENG-03

#### **Voices Calling from the Wilderness: The Poetry of James Wright and Mary Oliver**

Savannah A Cseko

Faculty Mentor: Professor Timothy Gray

### ENG-04

#### **Reimagining CSI's Writing Center: Strategies for Removing Stigma and Maximizing Impact**

Nicolette Randazzo

Faculty Mentor: Professor Melanie McNulty

### ENG-05

#### **Writing Centers as Sites of Resistance: Promoting Authenticity in Student Writing Processes**

Amina Selimaj

Faculty Mentor: Professor Melanie McNulty

### ENG-06

#### **Under Lock and Key: Analyzing the Detrimental Consequences of Banning Books for Students**

Maya Abdul-Rassoul

Faculty Mentor: Professor Lee Papa

---

## **HISTORY**

---

### HST-01

#### **Music in the 1900s: The Comparative Impacts of Duke Ellington and Robert Johnson**

Elliot Radov, Daniella Marcus, Teresa Ugolotti

Faculty Mentor: Professor Jane Marcus-Delgado

### HST-02

#### **Indigenous Allies and Smallpox: The True Downfall of Tenochtitlan**

Luan Draga

Faculty Mentor: Professor John Wing

### HST-03

#### **Indigenous Autonomy in Colonial Mexico: Survival and Acculturation Strategies of Native Peoples in the 16th Century**

Michael Plishchin

Faculty Mentor: Professor John Wing

---

## **MANAGEMENT**

---

### MGT-01

#### **Comparative Analysis of Social Media Approaches: A Case Study of Le Alfré, The Vibe, and SAM Sensory & More**

Francesco M Paone

Faculty Mentor: Professor Heidi Bertels

### MGT-02

#### **Event Management and Student Engagement in Higher Education**

Emily R Jimenez

Faculty Mentor: Professor Lauren Mullins



---

## MARKETING

---

### MKT-01

#### Social Media's Influence on the Fitness Industry

Gabriella Pipitone

Faculty Mentor: Professor Dan Zhang

### MKT-02

#### Uber vs. Lyft: Who is Winning the Battle in the Ride-Sharing Industry?

Thania Sibri

Faculty Mentor: Professor Dan Zhang

---

## MATHEMATICS

---

### MTH-01

#### Play-Based Learning that Connects Mathematical Ideas to Real-World Situations

Rolla Khass, Sahani Perera, Rebecca Moller

Faculty Mentor: Professor Judit Kerekes

### MTH-02

#### Addressing Math Anxiety in Middle and High School Classrooms: A Systematic Review

Matthew Keeler

Faculty Mentor: Professor Wenjuan Li

### MTH-03

#### Linear Algebraic Ornithology: On the Dynamic Mode Decomposition

Megan R Trapanese

Faculty Mentor: Professor Andrew C Poje

### MTH-04

#### Analysis of All the End Game Possibilities in Catch-up When There Are 3 or 4 Pieces Remaining

Kenny Chau Gin Feng

Faculty Mentor: Professor Joseph Quinn

### MTH-05

#### Investigation of Symmetric Point Clouds in Topological Data Analysis

Daniel O Hope

Faculty Mentor: Prof. Mikael Vejdemo-Johansson

---

## NURSING

---

### NRS-01

#### The Impact of COVID-19 on the Mental Health of Nurses Pre-, During, and Post-Pandemic

Keryn Lee

Faculty Mentor: Professor Karen Arca-Contreras

### NRS-02

#### Mental Health and the Context of the COVID-19 Pandemic in the Pediatric Population

Jenna Alijla

Faculty Mentor: Professor Susan J Brillhart

### NRS-03

#### **Determining the Relationship in Prevalence of Childhood Obesity and COVID-19**

Victoria Gniazdowski

Faculty Mentor: Professor Susan Brillhart

### NRS-04

#### **Postpartum Depression**

Melinda Bojkovic

Faculty Mentor: Professor Danna Curcio

### NRS-05

#### **Childhood Obesity**

Thomas Bossert

Faculty Mentor: Professor Danna Curcio

### NRS-06

#### **The Interplay between Anxiety and Anesthesia**

Nicole Gelfand

Faculty Mentor: Professor Danielle Hunton

### NRS-07

#### **Strategies to Promote HPV and Cervical Cancer Screenings in Lesbian and Bisexual Women**

Christina Testa

Faculty Mentor: Professor Marianne Jeffreys

### NRS-08

#### **Impacts of Overcrowding in the Emergency Department**

Julia E Calvo

Faculty Mentor: Professor Jennifer Macchiarola

### NRS-09

#### **Sleep Quality of Nurses during the COVID-19 Pandemic: A Literature Review**

Bryan Duraku

Faculty Mentor: Professor Magalie Pantermarakis

### NRS-10

#### **Literature Review about Healthcare Workers Who Cared for Patients with Coronavirus Disease (COVID-19), to Identify Rates of PTSD, Risk Factors, and Resilience Factors**

Nelson A Grajales

Faculty Mentor: Professor An-Yun Yeh

---

## **PHILOSOPHY**

---

### PHL-01

#### **Structural Injustice: The Bias and Disparities in the Criminal Justice System**

Jericee Mitchell

Faculty Mentor: Professor Mark White

---

## **PHYSICS & ASTRONOMY**

---

### PHY/AST-01

#### **Interactive Physics**

Kelly Zyko, Monae Sears, Marko Milosavljevic, Frederick Jones

Faculty Mentor: Professor Charles Liu

---

**POLITICAL SCIENCE &  
GLOBAL AFFAIRS**

---

**PSGA-01****Relationships between Restaurants and Cultures**

Sophia Artz, Emma Cahill, Isabelle Wallace

Faculty Mentor: Professor Jane Marcus-Delgado

**PSGA-02****Migration to New York from the Collapsed Soviet Union**

Vlada Kuzina, Max Caputo, Richard Zborovski

Faculty Mentor: Professor Jane Marcus-Delgado

**PSGA-03****The Great Migration, Jazz, and Race Relations: The Case of the Benny Goodman Quartet**

Angelina M Colamarino, Katarina Bartholomew

Faculty Mentor: Professor Jane Marcus-Delgado

**PSGA-04****Analyzing Public Transportation Infrastructure Disparities between Staten Island and Other Boroughs: A Comprehensive Examination of Cost, Services, Ridership, Reliability, and COVID-related Disruptions**

Lawrence Goldfeld, Briana Grijalva,

Oscar Contreras

Faculty Mentor: Professor Jane Marcus-Delgado

**PSGA-05****Fresh Kills Landfill Air Quality and Its Effects On Staten Island**

Mireyda Gonzalez, Annisa Desir

Faculty Mentor: Professor Jane Marcus-Delgado

**PSGA-06****Sports in New York: Unifying People and Cultures**

Dylan T Murphy, Ryan Spelman, Danny Smieya

Faculty Mentor: Professor Jane Marcus-Delgado

**PSGA-07****The Impact of Immigration Status on Healthcare Access and Quality**

Nada Nasr, Sarah Ahmed, Luke Zaloom

Faculty Mentor: Professor Jane Marcus-Delgado

**PSGA-08****Hamilton's Impact on New York City**

Mia Angelina Sinodinos, Gary Fleming

Faculty Mentor: Professor Jane Marcus-Delgado

**PSGA-09****Is the Condemnation of Modern-Day Sportswashing in MENA Nations Blown out of Proportion through Orientalism?**

Wahaj Ali

Faculty Mentor: Professor Halil Ege Ozen

### PSGA-10

#### **Life in Gaza before the Outbreak of Hostilities: A Study of Palestinian Experiences under Siege**

Karen Kellieh

Faculty Mentor: Professor Halil Ege Ozen

### PSGA-11

#### **Media Representations and the Dehumanization of Palestinians: Examining Patterns of Marginalization and Vilification**

Ayat J Odeh

Faculty Mentor: Professor Halil Ege Ozen

---

## **PSYCHOLOGY**

---

### PSY-01

#### **Emerging Research on the Specific Mechanisms of Sleep as They Relate to Optimal Productivity and Cognitive Function**

Zakary J Blyth

Faculty Mentor: Prof. Natalie Batman-Ratyosyan

### PSY-02

#### **Problem Solving Skills in Pre-term vs. Full-term Infants**

Aleena Arif

Faculty Mentor: Professor Sarah E Berger

### PSY-03

#### **Caregivers Impact on Infant Toy Exploration**

Jenna Como, Jordan Swanson

Faculty Mentors: Professor Sarah Berger and Michele Goncalves Maia

### PSY-04

#### **Cross-Cultural Comparison of Focused Attention in Infants from the United States, Brazil, and Tajikistan**

Tenzing Mathok, Abrar Alzandani

Faculty Mentor: Professor Sarah Berger

### PSY-05

#### **A Meta-Analysis of Emotion Recognition, Understanding, and Regulation in Children with Developmental Language Disorder**

Nicole Damiani

Faculty Mentors: Professor Patricia J Brooks and Elizabeth Che

### PSY-06

#### **Is Media Literacy Associated with Wikipedia Knowledge and Use?**

Hunter Peters

Faculty Mentors: Professor Patricia J Brooks and C Donnan Gravelle

**PSY-07****Intersectionality: Neurodiversity and LGBTQ+ Identities**

Alexandra J Lorenzo

**Faculty Mentor:** Professor Jennie Datre**PSY-08****What Contributes to Internalized Stigma among Autistic Youth?**

Reebu M Geevarughese

**Faculty Mentor:** Professor Kristen Gillespie-Lynch**PSY-09****Intersectional Representations of Identities in Queer Children's Literature**

Monica Ahuja

**Faculty Mentor:** Professor Darryl Hill**PSY-10****Race, Empowerment, and Disordered Eating among Women Who Have Experienced Intimate Partner Violence**

Andromeda Joseph

**Faculty Mentor:** Professor Samantha Holmes**PSY-11****Social Media and Attachment Post COVID-19**

Cheyanne L Richardson

**Faculty Mentor:** Professor Alisa Johnson**PSY-12****Gahvora's Embrace: Effects of Cradling on Nighttime Waking in Tajik Infants**

Francesca A Catalano

**Faculty Mentor:** Professor Lana Karasik**PSY-13****Breastfeeding in Context: Effects of Gahvora Cradling in Tajikistan**

Brian Villani

**Faculty Mentor:** Professor Lana Karasik**PSY-14****Gesture Production in Gahvora-reared Infants in Tajikistan**

Kristen F Vonfrolio

**Faculty Mentor:** Professor Lana Karasik**PSY-15****Nest-Initiation Patterns Demonstrate Differential Nest Attractors in African Naked Mole-Rat Subgroups**

Tina Li

**Faculty Mentor:** Professor Dan McCloskey**PSY-16****Measuring the Impact of Group Work on Individual Assignments**

Mariana Luperdi

**Faculty Mentor:** Professor Dan McCloskey

**PSY-17**

**An AI-Powered Approach to Naked Mole-Rat Nesting Patterns**

Stephanie L Tirado

Faculty Mentor: Professor Dan McCloskey

**PSY-18**

**Unlocking Hope: The Efficacy of Therapeutic Interventions in Alzheimer's Care**

Mennah Hegazi

Faculty Mentor: Professor Elizabeth Pete

**PSY-19**

**Afro-Latinx Youth: A Review of Literature and Clinical Recommendations**

Kelly Calixto

Faculty Mentor: Professor Lauren Rogers-Sirin

**PSY-20**

**An Independent Study on Disability Using Behavior Analysis**

Jacky Zhao

Faculty Mentor: Professor Louis A Rotondo

**PSY-21**

**The Effects of Social Isolation during Adolescence on Dopamine Axon Terminal Density in the Anterior Corpus Callosum**

Colin P Alarcon

Faculty Mentor: Professor Leora Yetnikoff

**PSY-22**

**The Effects of Repeated Amphetamine during Adolescence on Dopamine Terminal Innervation of the Corpus Callosum in Adult Mice**

Daniel Maronna

Faculty Mentor: Professor Leora Yetnikoff

---

**SOCIOLOGY & ANTHROPOLOGY**

---

**SOC/ANT-01**

**Supermarket Accessibility in Staten Island, New York: 10303 vs. 10314**

Keair E Brown

Faculty Mentor: Professor Grace Cho

**SOC/ANT-02**

**Racial Hegemonic Analysis: Exploring Theoretical Racial Structures in the Spanish Caribbean**

Daniel Hope

Faculty Mentor: Professor Ismael García-Colón

---

**WORLD LANGUAGES & LITERATURES**

---

**WL&L-01**

**By the Eyes of Primo Levi**

Jennifer De Litteris

Faculty Mentor: Professor Chiara Ferrari



# APPENDIX

STUDENT	FACULTY MENTOR	DEPARTMENT	POSTER ID
Ali Abdelmoneim	Neo Antoniades	Engineering & Environmental Sci	EES-01
Ali Abdelmoneim	Alfred Levine	Engineering & Environmental Sci	EES-09
Maya Abdul-Rassoul	Lee Papa	English	ENG-06
Jessica Abrajan	Judit Kerekes	Educational Studies	EDD-03
John Agro	George Vachadze	Economics	ECO-05
Nadeen Ahmad	Judit Kerekes	Educational Studies	EDD-03
Saira Ahmad	Faiza Peetz	Biology	BIO-17
Sarah Ahmed	Jane Marcus-Delgado	Political Science & Global Affairs	PSGA-07
Tasneem Ahsan	Krishnaswami Raja	Chemistry	CHM-07
Monica Ahuja	Darryl Hill	Psychology	PSY-09
Kehinde Aiyegboyin	Krishnaswami Raja	Chemistry	CHM-06
Naomi A Akan	Nancy Liu-Sullivan	Biology	BIO-10
Colin P Alarcon	Leora Yetnikoff	Psychology	PSY-21
Raghad Alhanoun	Grozdena Yilmaz	Biology	BIO-31
Wahaj Ali	Halil Ege Ozen	Political Science & Global Affairs	PSGA-09
Inna Alieva	Muhammad Zia	Biology	BIO-34
Jenna Alijla	Susan J Brillhart	Nursing	NRS-02
Paloma Almonte	Neo Antoniades, Yi Wang	Engineering & Environmental Sci Manhattan College	EES-03
Ambar Alvarenga	Nancy Liu-Sullivan	Biology	BIO-11
Abrar Alzandani	Sarah Berger	Psychology	PSY-04
Rebecca A Andes	Antonella Guadagnino	Biology	BIO-09
Aleena Arif	Sarah E Berger	Psychology	PSY-02
Sophia Artz	Jane Marcus-Delgado	Political Science & Global Affairs	PSGA-01
Aya Ashour	Alan Lyons	Chemistry	CHM-03
Ayah Atmani	Adrienne Paez	Biology	BIO-16
Anthony P Attenborough	Alan Lyons	Chemistry	CHM-04
Danielle Aurilia	Alfred Levine	Engineering & Environmental Sci	EES-06
Michael A Aurilia	Tatiana Anderson	Computer Science	CSC-03
Seifeldin Awad	George Vachadze	Economics	ECO-02
Abou Bah	Dimitrios Pavlidis	Engineering & Environmental Sci	EES-11
Salma Balogun	Shuiqin Zhou	Chemistry	CHM-10
Katarina Bartholomew	Jane Marcus-Delgado	Political Science & Global Affairs	PSGA-03
Nicholas Basile	Sos Agaian	Computer Science	CSC-01
Husein Bechara	Nancy Liu-Sullivan	Biology	BIO-12
Zakary J Blyth	Natalie Batman-Ratyosyan	Psychology	PSY-01



<b>STUDENT</b>	<b>FACULTY MENTOR</b>	<b>DEPARTMENT</b>	<b>POSTER ID</b>
Melinda Bojkovic	Danna Curcio	Nursing	NRS-04
Larisa Borruso	Krishnaswami Raja	Chemistry	CHM-08
Thomas Bossert	Danna Curcio	Nursing	NRS-05
Arianna Brillante	Ann N Etsey	Biology	BIO-06
Keair E Brown	Grace Cho	Sociology and Anthropology	SOC/ANT-01
Mary C Butler	Chang-Hui Shen	Biology	BIO-29
Emma Cahill	Jane Marcus-Delgado	Political Science & Global Affairs	PSGA-01
Kelly Calixto	Lauren Rogers- Sirin	Psychology	PSY-19
Julia E Calvo	Jennifer Macchiarola	Nursing	NRS-08
Alondra Camacho	Sean Thatcher	Engineering & Environmental Sci	EES-13
Victoria Cannava	Krishnaswami Raja	Chemistry	CHM-06
Max Caputo	Jane Marcus-Delgado	Political Science & Global Affairs	PSGA-02
Lauren Cardieri	Deirdre Armitage	Educational Studies	EDD-01
Caitlin R Carela	Nancy Liu-Sullivan	Biology	BIO-11
Francesca A Catalano	Lana Karasik	Psychology	PSY-12
Adrianna Catanzaro	Krishnaswami Raja	Chemistry	CHM-07
Chazz Chambliss	George Vachadze	Economics	ECO-05
Lily Chen	Nancy Liu-Sullivan	Biology	BIO-12
Joel Christian	Krishnaswami Raja	Chemistry	CHM-08
Angelina M Colamarino	Jane Marcus-Delgado	Political Science & Global Affairs	PSGA-03
Ahava Collado	Rupal Gupta	Chemistry	CHM-02
Jenna Como	Sarah Berger, Michele Goncalves Maia	Psychology	PSY-03
Oscar Contreras	Jane Marcus-Delgado	Political Science & Global Affairs	PSGA-04
Savannah A Cseko	Timothy Gray	English	ENG-03
Nicole Damiani	Patricia J Brooks, Elizabeth Che	Psychology	PSY-05
Branny De Jesus Santana	Faiza Peetz	Biology	BIO-18
Jennifer De Litteris	Chiara Ferrari	World Languages and Literatures	WL&L-01
Eve Deans	Nancy Liu-Sullivan	Biology	BIO-12
Ava Degratto	Judit Kerekes	Educational Studies	EDD-04
Madison DeGrazia	Zhanyang Zhang	Computer Science	CSC-08
Annisa Desir	Jane Marcus-Delgado	Political Science & Global Affairs	PSGA-05
Bhakti Dongerkery	Shuiqin Zhou	Chemistry	CHM-11
Stephen Dorazio	Alfred Levine	Engineering & Environmental Sci	EES-08
Luan Draga	John Wing	History	HST-02

STUDENT	FACULTY MENTOR	DEPARTMENT	POSTER ID
Bryan Duraku	Magalie Pantermarakis	Nursing	NRS-09
Gabrielle A Erves	Sarah Zelikovitz	Computer Science	CSC-07
Lauren Farley	Judit Kerekes	Educational Studies	EDD-04
Conor Farrell	Sarah Zelikovitz	Computer Science	CSC-06
Frank Feng	Neo Antoniades	Engineering & Environmental Sci	EES-01
Kenny Chau Gin Feng	Joseph Quinn	Mathematics	MTH-04
Gary Fleming	Jane Marcus-Delgado	Political Science & Global Affairs	PSGA-08
Fady U Frieg	Syed Rizvi	Engineering & Environmental Sci	EES-12
Tiana Garcia	Grozdena Yilmaz	Biology	BIO-32
Yamely Garcia	Patricia Galletta	Accounting and Finance	ACC/FNC-02
Almir Gashi	George Vachadze	Economics	ECO-02
Reebu M Geevarughese	Kristen Gillespie-Lynch	Psychology	PSY-08
Nicole Gelfand	Danielle Hunton	Nursing	NRS-06
Hailey Germoso	George Vachadze	Economics	ECO-03
Reyam Ghannoum	Wenjuan Li	Curriculum and Instruction	C&I-02
Sandra Ghobrial	Faiza Peetz	Biology	BIO-19
Raeshawn E Gibson	Nancy Liu-Sullivan	Biology	BIO-10
Victoria Gniazdowski	Susan Brillhart	Nursing	NRS-03
Lawrence Goldfeld	Jean-Philippe Berteau	Engineering & Environmental Sci	EES-04
Lawrence Goldfeld	Jane Marcus-Delgado	Political Science & Global Affairs	PSGA-04
Kayla Goldstein	Jason Bishop	English	ENG-01
Mireyda Gonzalez	Jane Marcus-Delgado	Political Science & Global Affairs	PSGA-05
Nelson A Grajales	An-Yun Yeh	Nursing	NRS-10
Briana Grijalva	Jane Marcus-Delgado	Political Science & Global Affairs	PSGA-04
Joseph Grillo	Alfred Levine	Engineering & Environmental Sci	EES-08
Alla Gubskiy	Muhammad Zia	Biology	BIO-34
Jackson Haft	Neo Antoniades, Yi Wang	Engineering & Environmental Sci Manhattan College	EES-03
Judie Hamdan	Krishnaswami Raja	Chemistry	CHM-05
Tasnim Hanaif	Krishnaswami Raja	Chemistry	CHM-07
Anusha Haris	Chang-Hui Shen	Biology	BIO-29
Mennah Hegazi	Elizabeth Pete	Psychology	PSY-18
Daniel O Hope	Mikael Vejdemo-Johansson	Mathematics	MTH-05
Daniel O Hope	Ismael García-Colón	Sociology and Anthropology	SOC/ANT-02
Eric Huang	Neo Antoniades	Engineering & Environmental Sci	EES-02
Michael Huang	Charles Liu	Physics and Astronomy	PHY/AST-01

<b>STUDENT</b>	<b>FACULTY MENTOR</b>	<b>DEPARTMENT</b>	<b>POSTER ID</b>
Jessica N Ifeanyi	Alejandra Alonso	Biology	BIO-02
Emmanuel Ijasuyi	Alfred Levine	Engineering & Environmental Sci	EES-10
Emily R Jimenez	Lauren Mullins	Management	MGT-02
Frederick Jones	Charles Liu	Physics and Astronomy	PHY/AST-01
Andromeda Joseph	Samantha Holmes	Psychology	PSY-10
Anxhela Josifi	Faiza Peetz	Biology	BIO-20
Anxhela Josifi	Faiza Peetz	Biology	BIO-21
Julia Kalinowski	Krishnaswami Raja	Chemistry	CHM-07
Irene Kalogiannis	Abdeslem El Idrissi	Biology	BIO-03
Mohammad Anas Kasem	Faiza Peetz	Biology	BIO-22
Matthew Keeler	Wenjuan Li	Mathematics	MTH-02
Ismaila Keita	George Vachadze	Economics	ECO-02
Sandi Kelada	Alejandra Alonso	Biology	BIO-01
Karen Kellieh	Halil Ege Ozen	Political Science & Global Affairs	PSGA-10
Brian Kerliu	Lisa Manne	Biology	BIO-13
Bayan Khalil	Judit Kerekes	Curriculum and Instruction	C&I-01
Rolla Khass	Judit Kerekes	Curriculum and Instruction	C&I-01
Rolla Khass	Ting Yuan	Curriculum and Instruction	C&I-03
Rolla Khass	Judit Kerekes	Mathematics	MTH-01
George N Khoury	Faiza Peetz	Biology	BIO-23
George N Khoury	Faiza Peetz	Biology	BIO-24
Shannon Killen	Krishnaswami Raja	Chemistry	CHM-06
Yuliya Kim	Nancy Liu-Sullivan	Biology	BIO-12
Maxim Kleyer	Sos Agaian	Computer Science	CSC-01
Andi Kolari	Sarah Zelikovitz	Computer Science	CSC-07
Marco Korcak	Zhanyang Zhang	Computer Science	CSC-08
Estella Kosse	Shiquin Zhou	Chemistry	CHM-12
Bora Kupa	Krishnaswami Raja	Chemistry	CHM-05
Bora Kupa	Krishnaswami Raja	Chemistry	CHM-08
Vlada Kuzina	Jane Marcus-Delgado	Political Science & Global Affairs	PSGA-02
Keryn Lee	Karen Arca-Contreras	Nursing	NRS-01
Leora Lehrfield	Michelle Esposito	Biology	BIO-05
Edward Leibowitz	Jimmie Fata	Biology	BIO-07
Michael Levitas	Alexandru Voicu	Economics	ECO-08
Tina Li	Dan McCloskey	Psychology	PSY-15
David Liao	Sos Agaian	Computer Science	CSC-02

<b>STUDENT</b>	<b>FACULTY MENTOR</b>	<b>DEPARTMENT</b>	<b>POSTER ID</b>
Alexandra J Lorenzo	Jennie Datre	Psychology	PSY-07
Thomas A Lovascio	George Vachadze	Economics	ECO-04
Mariana Luperdi	Dan McCloskey	Psychology	PSY-16
Albert Mackiewicz	Chang-Hui Shen	Biology	BIO-30
Kraya Macwan	Krishnaswami Raja	Chemistry	CHM-06
Kraya Macwan	Krishnaswami Raja	Chemistry	CHM-08
Marroquin Marcia	Alfred Levine	Engineering & Environmental Sci	EES-10
Daniella Marcus	Jane Marcus-Delgado	History	HST-01
Daniel Maronna	Leora Yetnikoff	Psychology	PSY-22
Tenzing Mathok	Sarah Berger	Psychology	PSY-04
Mirjana Mehmeti	Soon Ae Chun	Computer Science	CSC-04
Ashley Mesa	Jason Bishop	English	ENG-01
Marko Milosavljevic	Charles Liu	Physics and Astronomy	PHY/AST-01
Thomas Mishakin	George Vachadze	Economics	ECO-05
Jericee Mitchell	Mark White	Philosophy	PHL-01
Thikra Mohammad	Jason Bishop	English	ENG-01
Rebecca Moller	Judit Kerekes	Mathematics	MTH-01
Viktoriya Morozova	Krishnaswami Raja	Chemistry	CHM-05
Salwa Munir	Faiza Peetz	Biology	BIO-25
Salwa Munir	Faiza Peetz	Biology	BIO-26
Dylan T Murphy	Jane Marcus-Delgado	Political Science & Global Affairs	PSGA-06
Sabrina Musovic	Krishnaswami Raja	Chemistry	CHM-07
Qadar Naeem	Paul Orzechowski	Economics	ECO-01
Qadar Naeem	George Vachadze	Economics	ECO-03
Nada Nasr	Jane Marcus-Delgado	Political Science & Global Affairs	PSGA-07
Shontel D Nedderman	George Vachadze	Economics	ECO-06
Andrew W Ngai	Muhammad Zia	Biology	BIO-33
Morgan Novello	Lisa Manne	Biology	BIO-14
Gianna Occhiuto	Russell Rosen	Educational Studies	EDD-05
Ayat J Odeh	Halil Ege Ozen	Political Science & Global Affairs	PSGA-11
Ezekiel O Okedoyin	Alfred Levine	Engineering & Environmental Sci	EES-07
Milena E Olkhovetsky	Michelle Esposito	Biology	BIO-04
Theresa Pagani	Krishnaswami Raja	Chemistry	CHM-05
Theresa Pagani	Krishnaswami Raja	Chemistry	CHM-06
Julia Palka	Faiza Peetz	Biology	BIO-27
Francesco M Paone	Heidi Bertels	Management	MGT-01

<b>STUDENT</b>	<b>FACULTY MENTOR</b>	<b>DEPARTMENT</b>	<b>POSTER ID</b>
Francesca Papalia	Judit Kerekes	Educational Studies	EDD-03
Sahani Perera	Judit Kerekes	Mathematics	MTH-01
Hunter Peters	Patricia J Brooks, C Donnan Gravelle	Psychology	PSY-06
Raijan Peters	Lorenza Colonna	English	ENG-02
Cristina Pineda	Jason Bishop	English	ENG-01
Gabriella Pipitone	Dan Zhang	Marketing	MKT-01
Michael Plishchin	John Wing	History	HST-03
Elliot Radov	Jane Marcus-Delgado	History	HST-01
Abeer Ramadan	Judit Kerekes	Educational Studies	EDD-04
Nicolette Randazzo	Melanie McNulty	English	ENG-04
Jaclyn Regina	Marta Cabral	Educational Studies	EDD-02
Emily Ricciutti	Krishnaswami Raja	Chemistry	CHM-07
Cheyenne L Richardson	Alisa Johnson	Psychology	PSY-11
Marcelina Rokicki	Muhammad Zia	Biology	BIO-34
Bryan Rudshteyn	Alfred Levine	Engineering & Environmental Sci	EES-08
Sakina Saeed	Shuiqin Zhou	Chemistry	CHM-09
Monae Sears	Charles Liu	Physics and Astronomy	PHY/AST-01
Amina Selimaj	Melanie McNulty	English	ENG-05
Gadzhi Shakhnavazov	Muhammad Zia	Biology	BIO-35
Fiona Shehu	Nancy Liu-Sullivan	Biology	BIO-12
Warren Shum	Alfred Levine	Engineering & Environmental Sci	EES-09
Thania Sibri	Dan Zhang	Marketing	MKT-02
Mia Angelina Sinodinos	Jane Marcus-Delgado	Political Science & Global Affairs	PSGA-08
Danny Smieya	Jane Marcus-Delgado	Political Science & Global Affairs	PSGA-06
Jade Smith	Jason Bishop	English	ENG-01
Fady Soliman	Alfred Levine	Engineering & Environmental Sci	EES-06
Luciano Spagnuolo	Muhammad Zia	Biology	BIO-35
Ryan Spelman	Jane Marcus-Delgado	Political Science & Global Affairs	PSGA-06
Thomas J Strmel	Alfred Levine	Engineering & Environmental Sci	EES-10
Jordan Swanson	Sarah Berger Michele Goncalves Maia	Psychology	PSY-03
Evelyn J Tamay Flores	George Vachadze	Economics	ECO-07
Rachel Tbeile	Nancy Liu-Sullivan	Biology	BIO-12
Stephen Teiglee	George Vachadze	Economics	ECO-03
Christina Testa	Marianne Jeffreys	Nursing	NRS-07

<b>STUDENT</b>	<b>FACULTY MENTOR</b>	<b>DEPARTMENT</b>	<b>POSTER ID</b>
Stephanie L Tirado	Dan McCloskey	Psychology	PSY-17
Marie Darlande Toussaint	Nancy Liu-Sullivan	Biology	BIO-12
Megan R Trapanese	Andrew C Poje	Mathematics	MTH-03
Thanh Truong	Xin Jiang	Engineering & Environmental Sci	EES-05
Melina Turco	Nancy Liu-Sullivan	Biology	BIO-11
Sara Turku	Michelle Esposito	Biology	BIO-05
Teresa Ugolotti	Jane Marcus-Delgado	History	HST-01
Leah A Vega	Banu Aslanertik	Accounting and Finance	ACC/FNC-01
Brian Villani	Lana Karasik	Psychology	PSY-13
Kristen F Vonfrolio	Lana Karasik	Psychology	PSY-14
Isabelle Wallace	Jane Marcus-Delgado	Political Science & Global Affairs	PSGA-01
Savion E Watson	Sarah Zelikovitz	Computer Science	CSC-07
Xinyi Weng	Jimmie Fata	Biology	BIO-08
Erin Westgate	Judit Kerekes	Educational Studies	EDD-04
Robert Wetz	Susan Imberman	Computer Science	CSC-05
Joseph Williams	Alfred Levine	Engineering & Environmental Sci	EES-07
Daniel Wronski	Leah Cohen	Chemistry	CHM-01
Joey Yu	Lisa Manne	Biology	BIO-15
Joey Yu	Muhammad Zia	Biology	BIO-34
Luke Zaloom	Jane Marcus-Delgado	Political Science & Global Affairs	PSGA-07
Justin Zaluk	Zhanyang Zhang	Computer Science	CSC-08
Richard Zborovski	Jane Marcus-Delgado	Political Science & Global Affairs	PSGA-02
Guohong Zhao	Xin Jiang	Engineering & Environmental Sci	EES-05
Jacky Zhao	Louis A Rotondo	Psychology	PSY-20
Jason Zheng	Neo Antoniades, Yi Wang	Engineering & Environmental Sci Manhattan College	EES-03
Amina Ziani	Faiza Peetz	Biology	BIO-28
Kelly Zyko	Charles Liu	Physics and Astronomy	PHY/AST-01

DEPARTMENT	FACULTY NAME	POSTER ID
Accounting and Finance	Banu Aslanertik	ACC/FNC-01
	Patricia Galletta	ACC/FNC-02
Biology	Alejandra Alonso	BIO-01, BIO-02
	Abdeslem El Idrissi	BIO-03
	Michelle Esposito	BIO-04, BIO-05
	Ann N Etsey	BIO-06
	Jimmie Fata	BIO-07, BIO-08
	Antonella Guadagnino	BIO-09
	Nancy Liu-Sullivan	BIO-10, BIO-11, BIO-12
	Lisa Manne	BIO-13, BIO-14, BIO-15
	Adrienne Paez	BIO-16
	Faiza Peetz	BIO-17, BIO-18, BIO-19, BIO-20, BIO-21, BIO-22, BIO-23, BIO-24, BIO-25, BIO-26, BIO-27, BIO-28
	Chang-Hui Shen	BIO-29, BIO-30
	Grozdena Yilmaz	BIO-31, BIO-32
Muhammad Zia	BIO-33, BIO-34, BIO-35	
Chemistry	Leah Cohen	CHM-01
	Rupal Gupta	CHM-02
	Alan Lyons	CHM-03, CHM-04
	Krishnaswami Raja	CHM-05, CHM-06, CHM-07, CHM-08
	Shuiqin Zhou	CHM-09, CHM-10, CHM-11, CHM-12
Computer Science	Sos Agaian	CSC-01, CSC-02
	Tatiana Anderson	CSC-03
	Soon Ae Chun ( <i>Department of Marketing</i> )	CSC-04
	Susan Imberman	CSC-05
	Sarah Zelikovitz	CSC-06, CSC-07
	Zhanyang Zhang	CSC-08
Curriculum and Instruction	Judit Kerekes	C&I-01
	Wenjuan Li	C&I-02
	Ting Yuan	C&I-03
Economics	Paul Orzechowski	ECO-01
	George Vachadze	ECO-02, ECO-03, ECO-04, ECO-05, ECO-06, ECO-07
	Alexandru Voicu	ECO-08
Educational Studies	Deirdre Armitage	EDD-01

DEPARTMENT	FACULTY NAME	POSTER ID
	Marta Cabral	EDD-02
	Judit Kerekes ( <i>Dept. of Curriculum &amp; Instruction</i> )	EDD-03, EDD-04
	Russell Rosen	EDD-05
Engineering and Environmental Science	Neo Antoniades	EES-01, EES-02, EES-03
	Yi Wang ( <i>Manhattan College</i> )	EES-03
	Jean-Philippe Berteau ( <i>Dept of Physical Therapy</i> )	EES-04
	Xin Jiang	EES-05
	Alfred Levine	EES-06, EES-07, EES-08, EES-09, EES-10
	Dimitrios Pavlidis	EES-11
	Syed Rizvi	EES-12
	Sean Thatcher	EES-13
English	Jason Bishop	ENG-01
	Lorenza Colonna	ENG-02
	Timothy Gray	ENG-03
	Melanie McNulty	ENG-04, ENG-05
	Lee Papa	ENG-06
History	Jane Marcus-Delgado ( <i>Dept. of Poli Sci &amp; Global Affairs</i> )	HST-01
	John Wing	HST-02, HST-03
Management	Heidi Bertels	MGT-01
	Lauren Mullins	MGT-02
Marketing	Dan Zhang	MKT-01, MKT-02
Mathematics	Judit Kerekes ( <i>Dept. of Curriculum &amp; Instruction</i> )	MTH-01
	Wenjuan Li	MTH-02
	Andrew C Poje	MTH-03
	Joseph Quinn	MTH-04
	Mikael Vejdemo-Johansson	MTH-05
Nursing	Karen Arca-Contreras	NRS-01
	Susan J Brillhart	NRS-02, NRS-03
	Danna Curcio	NRS-04, NRS-05
	Danielle Hunton	NRS-06
	Marianne Jeffreys	NRS-07
	Jennifer Macchiarola	NRS-08



DEPARTMENT	FACULTY NAME	POSTER ID
	Magalie Pantermarakis	NRS-09
	An-Yun Yeh	NRS-10
Philosophy	Mark White	PHL-01
Physics and Astronomy	Charles Liu	PHY/AST-01
Political Science and Global Affairs	Jane Marcus-Delgado	PSGA-01, PSGA-02, PSGA-03, PSGA-04, PSGA-05, PSGA-06, PSGA-07, PSGA-08
	Halil Ege Ozen	PSGA-09, PSGE-10, PSGA-11
Psychology	Natalie Batman-Ratyosyan	PSY-01
	Sarah E Berger	PSY-02, PSY-03, PSY-04
	Patricia J Brooks	PSY-05, PSY-06
	Elizabeth Che	PSY-05
	Jennie Datre	PSY-07
	Kristen Gillespie-Lynch	PSY-08
	Michele Goncalves Maia	PSY-03
	Christopher Donnan Gravelle	PSY-06
	Darryl Hill	PSY-09
	Samantha Holmes	PSY-10
	Alisa Johnson	PSY-11
	Lana Karasik	PSY-12, PSY-13, PSY-14
	Dan McCloskey	PSY-15, PSY-16, PSY-17
	Elizabeth Pete	PSY-18
	Lauren Rogers- Sirin	PSY-19
	Louis A Rotondo	PSY-20
	Leora Yetnikoff	PSY-21, PSY-22
Sociology and Anthropology	Grace Cho	SOC/ANT-01
	Ismael García-Colón	SOC/ANT-02
World Languages and Literatures	Chiara Ferrari	WL&L-01

## MACAULAY HONORS

Sarah Ahmed  
 Tasneem Ahsan  
 Colin P Alarcon  
 Jenna Alijla  
 Sophia Artz  
 Aya Ashour  
 Anthony P Attenborough  
 Katarina Bartholomew  
 Nicholas Basile  
 Melinda Bojkovic  
 Thomas Bossert  
 Emma Cahill  
 Alondra Camacho  
 Victoria Cannava  
 Max Caputo  
 Adrianna Catanzaro  
 Angelina M Colamarino  
 Ahava Collado  
 Jenna Como  
 Oscar Contreras  
 Madison DeGrezia  
 Annisa Desir  
 Bryan Duraku  
 Gabrielle A Erves  
 Frank Feng  
 Kenny Chau Gin Feng  
 Gary Fleming  
 Victoria Gniazdowski  
 Lawrence Goldfeld  
 Mireyda Gonzalez  
 Nelson A Grajales  
 Briana Grijalva  
 Tasnim Hanaif  
 Eric Huang  
 Jessica N Ifeanyi  
 Julia Kalinowski

MACAULAY HONORS *(continued)*

Matthew Keeler  
 Brian Kerliu  
 Maxim Kleyer  
 Andi Kolari  
 Marco Korcak  
 Vlada Kuzina  
 Keryn Lee  
 Leora Lehrfield  
 Daniella Marcus  
 Dylan T Murphy  
 Sabrina Musovic  
 Nada Nasr  
 Milena E Olkhovetsky  
 Francesco M Paone  
 Michael Plishchin  
 Elliot Radov  
 Emily Ricciutti  
 Warren Shum  
 Mia Angelina Sinodinos  
 Danny Smieya  
 Luciano Spagnuolo  
 Ryan Spelman  
 Jordan Swanson  
 Stephanie L Tirado  
 Megan R Trapanese  
 Sara Turku  
 Teresa Ugolotti  
 Brian Villani  
 Isabelle Wallace  
 Savion E Watson  
 Daniel Wronski  
 Joey Yu  
 Luke Zaloom  
 Justin Zaluk  
 Richard Zborovski

## VERRAZZANO HONORS

Maya Abdul-Rassoul  
 Naomi A Akan  
 Wahaj Ali  
 Abrar Alzandani  
 Rebecca A Andes  
 Ayah Atmani  
 Danielle Aurilia  
 Michael A Aurilia  
 Zakary J Blyth  
 Arianna Brillante  
 Keair E Brown  
 Kelly Calixto  
 Julia E Calvo  
 Lauren Cardieri  
 Savannah A Cseko  
 Nicole Damiani  
 Jennifer De Litteris  
 Luan Draga  
 Reebu M Geevarughese  
 Nicole Gelfand  
 Reyam Ghannoum  
 Anusha Haris  
 Mennah Hegazi  
 Emily R Jimenez  
 Irene Kalogiannis  
 Sandi Kelada  
 Bayan Khalil  
 Rolla Khass  
 Tina Li  
 Alexandra J Lorenzo  
 Mariana Luperdi  
 Jericee Mitchell  
 Thikra Mohammad  
 Qadar Naeem  
 Morgan Novello  
 Gianna Occhiuto

**VERRAZZANO HONORS** (continued)

Julia Palka  
Raijan Peters  
Jaclyn N Regina  
Cheyanne L Richardson  
Bryan Rudshiteyn  
Sakina Saeed  
Gadzhi Shakhnazov  
Rachel Tbeile  
Christina Testa  
Kristen F Vonfrolio  
Xinyi Weng  
Erin Westgate  
Robert Wetz  
Kai White

**CUNY RESEARCH SCHOLARS**

Ambar Alvarenga  
Abou Bah  
Caitlin R Carela  
Fady U Frieg  
Kayla Goldstein  
David Liao  
Ashley Mesa  
Cristina Pineda  
Jade Smith  
Melina Turco

Cheryl Adolph	Institutional Advancement & External Affairs
Alyson Bardsley	Dept. of English; Co-Director for Writing Across the Curriculum
Bill Bauer	Dept. of Performing & Creative Arts
Fausto Canela	Faculty Center for Teaching, Learning, & Professional Development
Rosanne Carlo	Department of English; Co-Director for Writing Across the Curriculum
Cynthia Chris	Department of Media Culture
Cheryl Craddock	Verrazzano Honors Program
Nina Del Gatto	Office of the Provost / Academic Affairs
Crystal Deosaran	Alumni Relations
Aleksander Dudek	Information Technology Services
Rosmary Frangoulis	Sponsored Programs & Research
Mariya Gershkovich	Information Technology Services
Sara Gold	Design Services
Philip Halsey	Reprographics
Maria Ivanova	CUNY Research Scholars Program
John Jankowski	Center for the Arts
Jacqueline Lamberti	Alumni Relations & Annual Giving
Mark Lewental	Information Technology Services
Lisa LoPorto	Macaulay Honors College
Terry Mares	Office of Communications & Marketing
Cate Marvin	Department of English
Jodi Merendino	Auxiliary Services
Jennifer Miller	Alumni Association
Donna Oliva	Sponsored Programs & Research
David Pizzuto	Communications & Marketing
Anita Romano	Macaulay Honors College
Sarolta Takács	Dean of Humanities & Social Sciences
Joyce Taylor	Information Technology Services
Priscila Villacis	Sponsored Programs & Research
Rosemary Vitale	Office of the President
Christina Werkmeister	Dept. of Performing & Creative Arts
Siona Wilson	Dept. of Performing & Creative Arts

### **Writing Across the Curriculum Fellows:**

Armando Escobar Gomez  
Filippo Fabbriatorre  
Juan Carlos Garcia  
Ivana Prelevic  
Nicole Zapparrata

---

### **Organizers**

Laxmi Ramasubramanian and Lynne Lacomis

### **Office of the Associate Provost for Faculty Success**

College of Staten Island, 2800 Victory Boulevard, Bldg. 1A - 211  
Staten Island, NY 10314

In addition, we gratefully acknowledge the contributions of the many individuals, including student volunteers, who helped make this Conference possible.







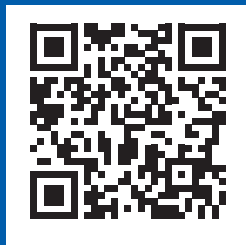

Scan here for more  
conference information